

Elizabeth Street, Atherton, M46 9JB
Offers Over £170,000



BALMER & CO in ATHERTON are delighted to offer FOR SALE this three bedroom semi detached true bungalow located on Elizabeth Street in Atherton. Although it requires refurbishment it is a fantastic size, offered with no onward chain and is conveniently placed for easy access to the town centre offering a range of amenities including shops, bars & restaurants and the V2 bus stop. Comprising in brief; entrance hallway with storage cupboard, living room with electric fireplace, fitted kitchen, two double bedrooms, a single bedroom and a large four piece bathroom suite. An integral garage with electric door completes the accommodation. Externally, there are gardens to the front and rear as well as driveway parking. Early viewings highly recommended, all enquiries welcome.

Floor Plan

GROUND FLOOR
1005 sq.ft. (93.3 sq.m.) approx.

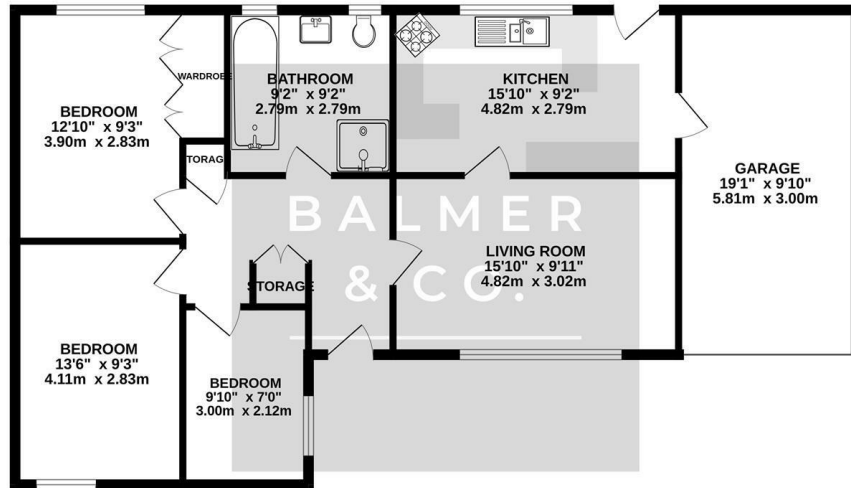

TOTAL FLOOR AREA: 1005 sq.ft. (93.3 sq.m.) approx.
Whilst every attempt has been made to ensure the accuracy of the floorplan contained here, measurements of doors, windows, rooms and any other items are approximate and no responsibility is taken for any error, omission or mis-statement. This plan is for illustrative purposes only and should be used as such by any prospective purchaser. The services, systems and appliances shown have not been tested and no guarantee as to their operability or efficiency can be given.
Made with Metropix ©2025

Area Map



Energy Efficiency Graph

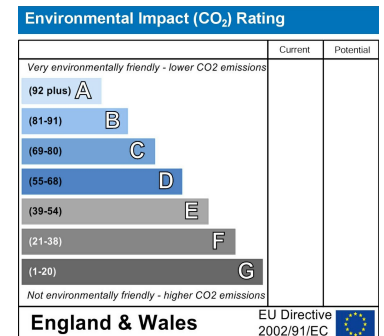
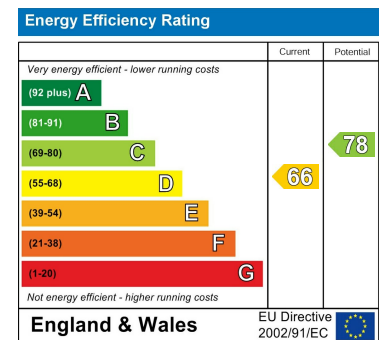

These particulars, whilst believed to be accurate are set out as a general outline only for guidance and do not constitute any part of an offer or contract. Intending purchasers should not rely on them as statements of representation of fact, but must satisfy themselves by inspection or otherwise as to their accuracy. No person in this firm's employment has the authority to make or give any representation or warranty in respect of the property.